



ALL VENTS PROUDLY MADE IN THE USA

PLEASE READ ALL INSTRUCTIONS PRIOR TO INSTALLATION OF VENT



(BSV-1) STICK-ON VENT

For Plastic and/or Synthetic Material Coverings

1. Select an area on Shrink-Film for ventilator installation AFTER film covering has been heated, shrunk and sealed.

For best results, locate vent at the highest angular section of covering. AVOID SEAMS, FOLDS or DEEP PERMANENT CREASES. Surface should be smooth, clean, dry and free of grease or oil. Ambient air temperature should be above 50°F (10°C). Use heat gun to warm surfaces if ambient/surface temp is below 50°F.

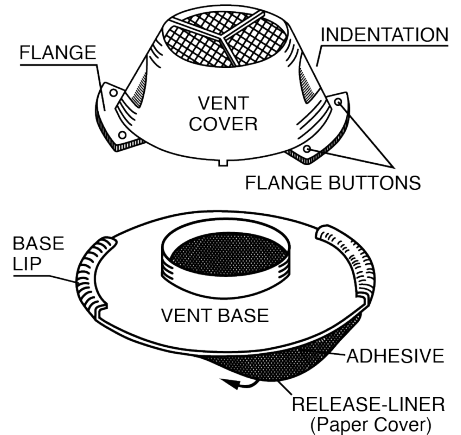

2. Remove vent COVER by applying pressure at two (2) indented areas (press inward toward center) until FLANGE is clear of BASE LIP.

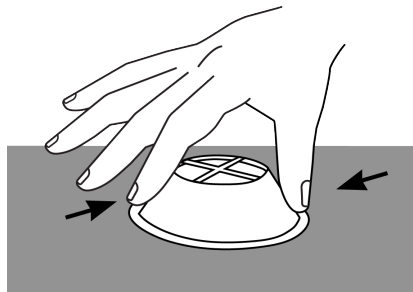

3. Remove RELEASE-LINER (papercover) from adhesive section of vent (located on the underside of BASE) and place BASE onto selected mounting area. Press gently into place.

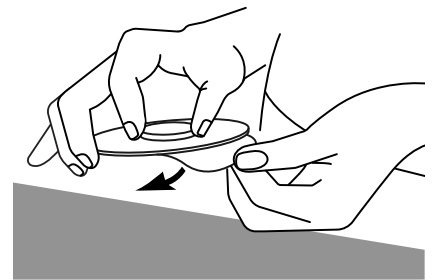

4. Cut through shrink-film covering material at center of vent. Remove all covering material from vent opening.

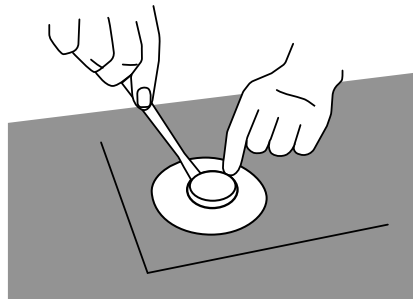

5. Press vent firmly into place by applying pressure to both sides of Base perimeter.

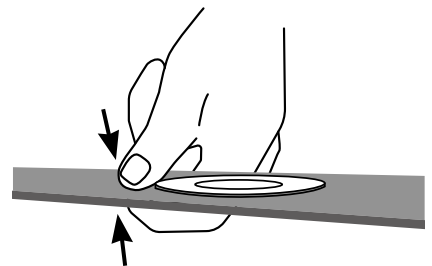

6. Replace vent COVER by applying pressure at two (2) indented areas. Press inward toward center and place both FLANGE areas UNDER Base Lips. Note: Two (2) buttons on FLANGE should be located OUTSIDE of BASE LIPS

